

**Product features:**

- Metal construction throughout
- Single lever control for effortless single handed control
- Adjustable to suit various thickness of wall
- Elegant minimalist design styling with a softened edge

**Packaged properties:**

**Box length:** 270 mm      **Box depth:** 180 mm  
**Box width:** 225 mm      **Boxed weight:** 2.17 kg

**Includes pop up waste?:** No

**Additional comments:**  
 Includes 2.5mm allen key & tiling depth guide

**Product dimensions:**

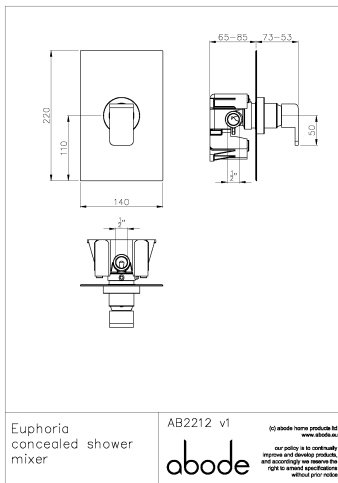

- **Overall Height / projection:** 73 mm
- **Exit reach:**
- **Exit height:**
- **Centre distance(s):**
- **Base diameter(s):** 140 x 220 mm
- **Product mounted where:** Wall
- **Recommended hole diameter:**
- **Min. fitting depth required:** 78-95 mm
- **Max. surface depth:**

**Product flow characteristics:**

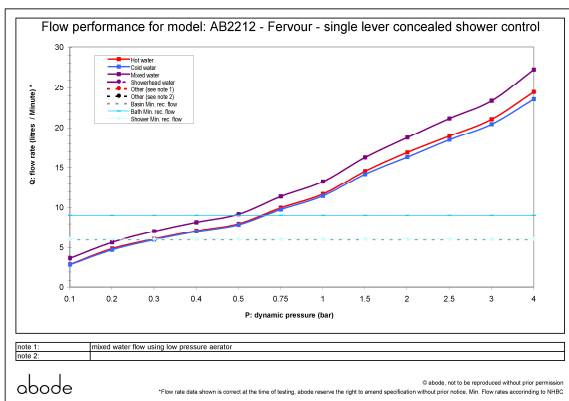

- **Min / Max water pressure:** 0.3 min. & 0.5 pref. / 5 bar
- **Part G mixed flow rate at 3 bar (l/m):** 23.3
- **Max water temperature:** 70° C
- **Product flow characteristics:** Single flow
- **Aerator type:**
- **Includes output diverter?:** No
- **Control valve type:** Single lever (35mm)
- **Non return valve position:**
- **Mesh particle filter size:**
- **Inlet / outlet size:** 1/2" F / 1/2" F
- **Inlet type / length:** Fixed / mm
- **Shower hose type / length:**

**Warranty Summary (Full details available on request):**

- Materials and workmanship defects warranted for 5 years
- Valves and working parts warranted for 2 years
- Surface warranty defects warranted for 1 year
- O-rings, hoses & gaskets warranted for 1 year

**Care instructions:**

- Clean the mixers and showers regularly as required, using soap, do not use any other cleaners.
- Regular cleaning will prevent the build up of lime scale and dirt
- After cleaning rinse thoroughly with clean water to remove any cleaner residue
- Residues of liquid soaps, shampoos and shower foams can also cause damage, so rinse with clean water after using, avoid contact with any abrasives