

PRODUCT INSTRUCTIONS

Product Code **33370** Product Description **KYNA-COLT KINETIC RAM**

Clearing Completely blocked
 Wash Basins, Showers, Baths
 Sinks, Urinals, etc.

Charge the Kyna-Colt.
 Plug the overflow.

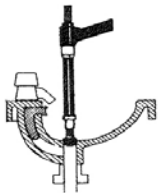

Select and insert the
 universal plug hole disc
 in the plug hole.
 Insert the nozzle of the
 Kyna-Colt into the hole
 in the cone.
 With full weight on the
 Kyna-Colt press down to
 discharge.

SLAB URINALS

Remove the Balloon Grating
 from gully outlet.

Select and insert the
 universal plug hole disc
 in the plug hole.

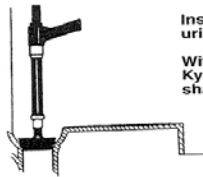

Charge the Kyna-Colt.
 Insert the cone into the
 urinal hole.
 With full weight on
 Kyna-Colt press down
 sharply to discharge.

BOWL URINALS

Select and insert the
 universal plug hole disc
 in the plug hole.

Charge the Kyna-Colt.

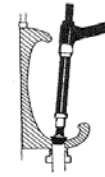

With full weight on the
 Kyna-Colt push down to
 discharge.

SINKS WITH VERTICAL OVERFLOWS

Proceed the same as normalsinks
 but block the
 overflow by hammering
 home a wooden wedge
 wrapped in cloth.

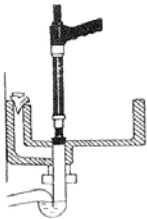

SINKS WITH VERTICAL OVERFLOWS

Proceed the same as normalsinks
 but block the
 overflow by hammering
 home a wooden wedge
 wrapped in cloth.

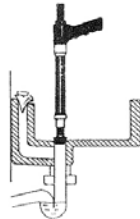

CLEARING W.C.'s

1. Lift the seat.
2. Fit the W.C. disc to the discharge nozzle.
3. Charge KYNA-Colt with ONE CO₂ bulb.
4. Insert the W.C. disc into the flush hole of the W.C. pan taking care not to discharge the KYNA-Colt.
5. Open a plastic garbage sack and cover the KYNA-Colt and pedestal within the bag so that they are enclosed.
6. Replace seat.
7. Find the handle of the KYNA-Colt in the sack, line up the nozzle in the bottom of the pan, with one knee on the seat push down sharply to discharge.

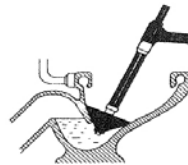

COMBINATION SINKS AND URINALS

Find the nearest drain hole to the
 blockage. (This is the one which,
 when the blockage occurred, filled first).
 Cover the other basins with a heavy
 wet cloth. Proceed the same as
 normal sinks.

